



15 Years Of Experiences In Smart House Market



# JOHA Product Catalogue

# COMPANY PROFILE



The JOHA Industry is belong toJoha Mei Lau, Hong Kong, which is a high-tech enterprise specilizing in the research, development, production and sales of capsule house and tiny house. JOHA is dedicated to offering a sophisticated and smart micro-hotel solution for hotel, resort, and Airbnb. JOHA develops an innovative, high-design, self-contained cabin that uses prefab structural components to reduce disturbance to the site and minimize environmental impact. JOHA provides travelers with the appeal of "living in the scenery. JOHA's factory is located inHong Kong. With a 40,000 square meter factory and 200 workers, the company employs an ERP and MES production management execution system, which allows it to produce up to 500 houses per month while reducing lead times to 20-25 days. JOHA offers a full suite of design and development solutions for large-scale projects and is available in both complete and disassembled shipments, with disassembled shipments that will reduce the cost of shipping for high volume purchases.

# BRAND INTRODUCTION



## Independent research and development

JOHA industry is committed to scientific and technological innovation, has a top design team and manufacturing plant, the use of industry advanced energy saving, building structure technology, invested in the research and development of Apple cabin"products, to create a variety of conditions to meet the living conditions of comfortable hotel products, for people to bring more travel and lifestyle

## High efficiency, high quality and cost-effective

No foundation, applicable to all terrain, no damage to the ecological environment, no building waste, ecological environmental protection. In the factory, 40 days of production, assembly and disassembly, integrated transportation, 2 hours of on-site installation, no need for secondary decoration, shorten the construction cycle, equipped with fully intelligent home appliance control system, panoramic vision, own flow

## Product quality and service are guaranteed

The main structure of the product is special steel structure. The design stability of the structure is strong, and the wind resistance is strengthened. The main material is made of high strength composite material and galvanized sheet, which has high safety and strong protection. By professional soft decoration designers to create space design scheme for customers, design team/architect team. According to the actual situation of the project and customer requirements, planning and design, including consulting, overall planning, space design,supporting facilities. Construction drawing, etc.

## Rich export experience

We have rich export experience and have exported to many countries including the United States, Australia, Greece, Indonesia, Philippines, South Korea, Saudi Arabia, etc. Reaching 80 countries, Our Factory Area 40,000 square meters Annual Production Capacity 6000 units, Production Cycle: 25 days.

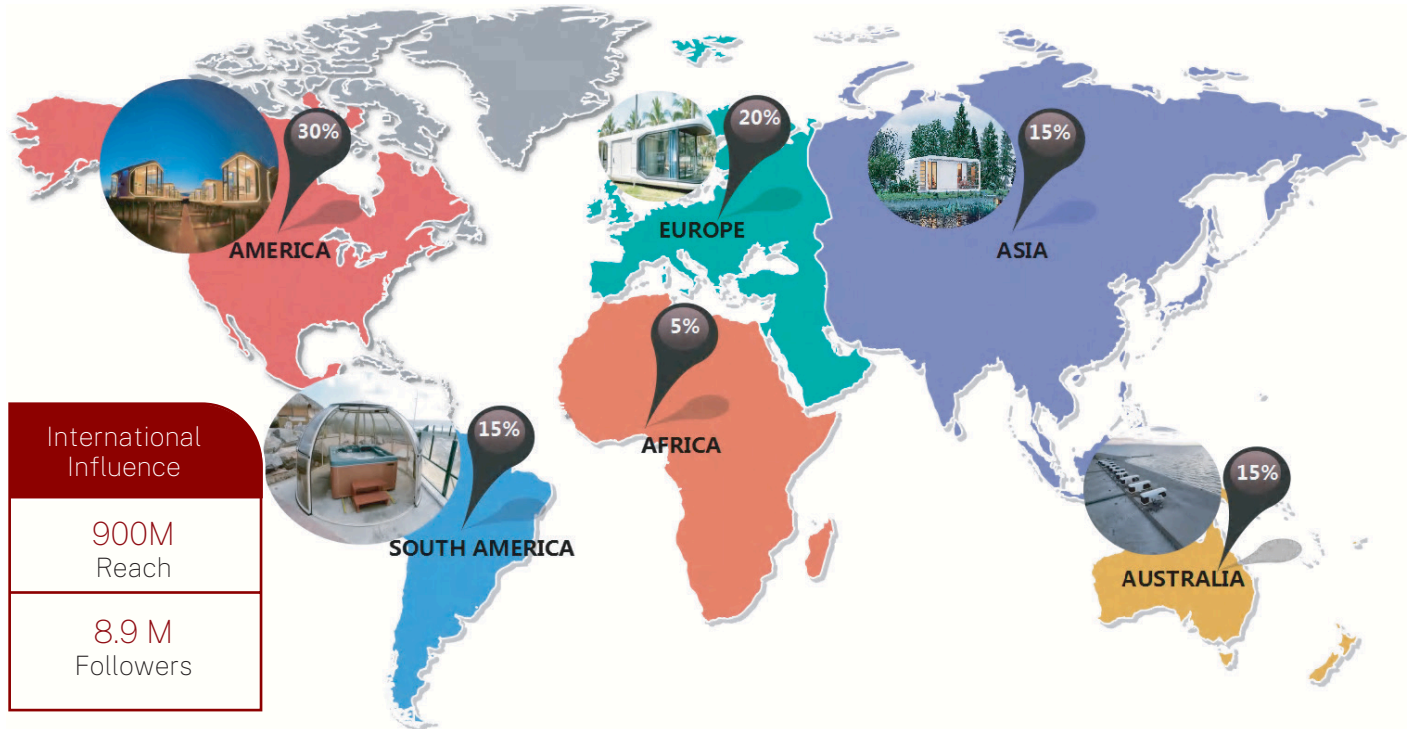

## COOPERATION BRAND



EMAAR Group in UAE



JOHA Australia in Australia



KARMA Group in Cyprus



Mira Group in Russia



LUXX Light Technology in USA



Arca Capsule House in Greece



HERA Holiday Home in UAE



Adv-con in Saudi Arabia



Albaddad Capital in UAE



Holo Homes in USA

### Better material selection

Layers of screening, the use of better materials than the market, craftsmanship, in order to produce high quality products, so that customers more trust in our brand.

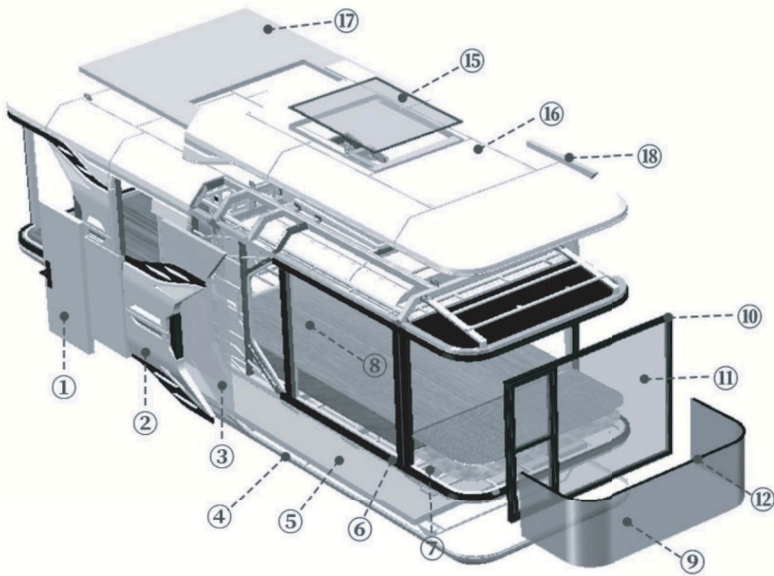

1. Stainless Steel Security Door	11. LOW-E 8+12A+8 Tempered Glass
2. Aviation Aluminum 2.5mm thick housing	12. Stainless Steel Handrail
3. LOW-E 8+12A+8 Tempered Glass	13. Cement Fiber Board
4. Bottom: Aviation Aluminum Panel	14. SPC Flooring + Moisture-proof Cotton
5. Bottom: Polyurethane Thermal Insulation	15. 6+1.5mm+6 Laminated Glass
6. Galvanized Steel Tube Frame structure	16. Aviation Aluminum Exterior trim plate
7. Galvanized Sheet Sandwich Plate	17. Top: Polyurethane Thermal Insulation
8. Wood Plastic Composites Board	18. Side: Polyurethane Thermal Insulation
9. 6+1.5mm+6 Laminated	19. Side: Polyurethane Thermal Insulation
10. Bridge-cutoff Aluminum Alloy	20. Bottom&Side: OSB board + Metal Plate

### R&D Design

According to international production standards, the structure is more robust.



### Process technology

Continuously innovate and upgrade, optimizing the appearance.

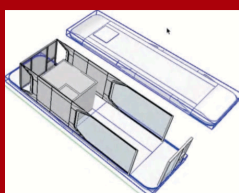

### All-round Upgrade

More advanced assembly and disassembly processes

# OUR 01 CUSTOMERS

## Dubai Emaar Properties (EMAAR)

The largest real estate developer in the Middle East and one of the top ten real estate developers. Since its establishment in 1997, Mohamed Alabbar has grown from a local company to a global presence. He was born in 1956 and is a businessman and global entrepreneur from the United Arab Emirates. He is the founder and chairman of Emaar Properties and a developer of the Khalifa Tower and Dubai Shopping Center. He is also the founder and director of an e-commerce giant Noon.com, and the chairman of the largest GCC e-commerce company in the Arab world and the US Food Industry Group. Mohamed Alabbar works for the government and serves as the founding.



## 0 CUSTOMERS

### OUR

## JOHA Korea

JOHA Korea is a Korean agency established by a Korean listed company in cooperation with JOHA Hong Kong. It is located in the prime location of 8, Eonju-ro 153-gil, Gangnam-gu, Seoul, Republic of Korea. JOHA Korea has four exhibition halls in Korea. Located in Yeosu (Exhibition Hall), Pre-Sales/LAGOM World, Jeju Island (Pavilion), Gangwon Province (Exhibition Hall) JOHA



## 0 CUS3TOMERS

### OUR

LLC "Mira group"

The company is committed to building houses for permanent residence and vacation. The years of experience of our staff allow us to combine the key capabilities of modern house construction. Such as professional design, original design, high-quality factory production, housing installation, including in hard-to-reach places.



## 0 CUS4TOMERS

### OUR

PAP GROUP

With a remarkable legacy spanning over 50 years, PAP Group stands as a globally recognized company, renowned for taking part in groundbreaking projects and exploring the possibilities of innovative ideas.



## 0 CUS5TOMERS

### OUR

HOUSE OF HABITATS

Its parent company 4x4built has been operating in the Australian construction industry for more than 20 years. The company's board members are familiar with housing construction/interior design/building standards/operation and promotion/import and export and other related fields. They are committed to deeply integrating prefabricated houses with the local market and bringing better living experience to Australian citiz. import and export and other related fields. They are committed to deeply integrating prefabricated houses with the local market and bringing better living experience to Australian citiz.



# JH-E6



Size: 8500\*3200\*3200mm Area of structure: 27.2 Accommodate up to: 3-4 people

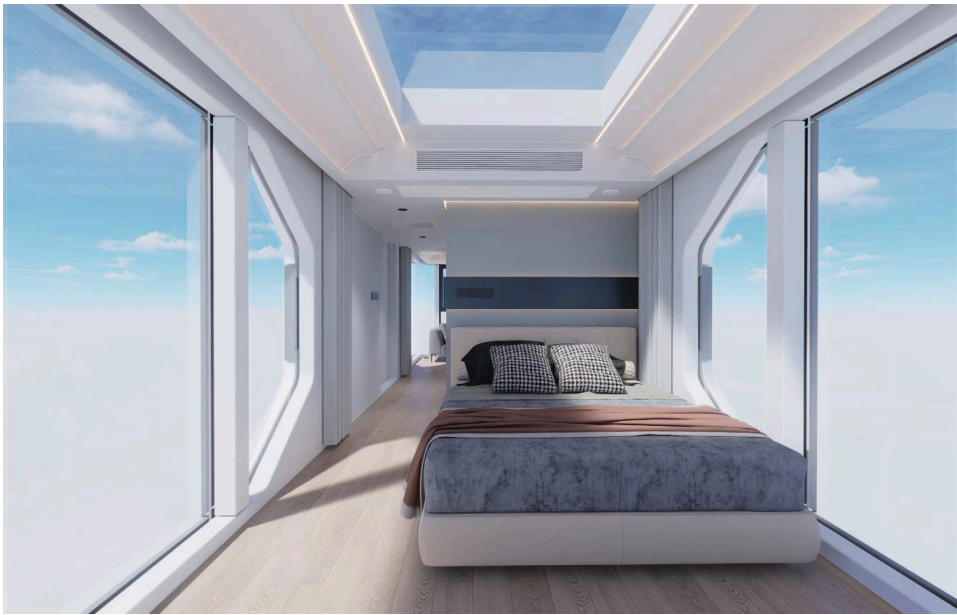

No balcony

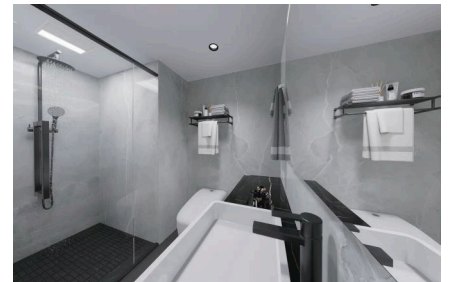

Balcony Type

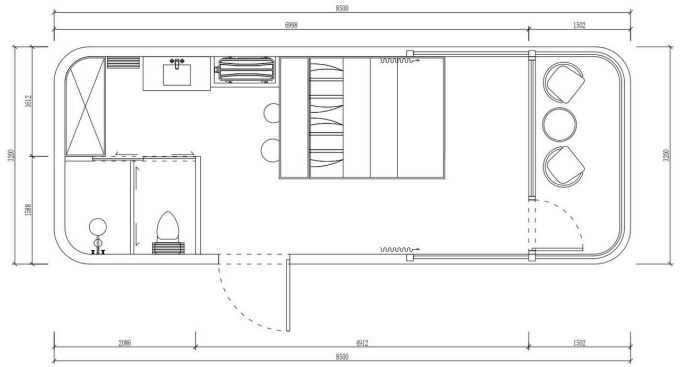
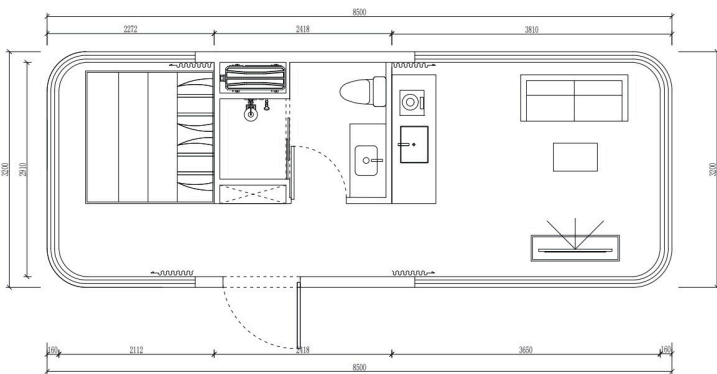

# JH-E8

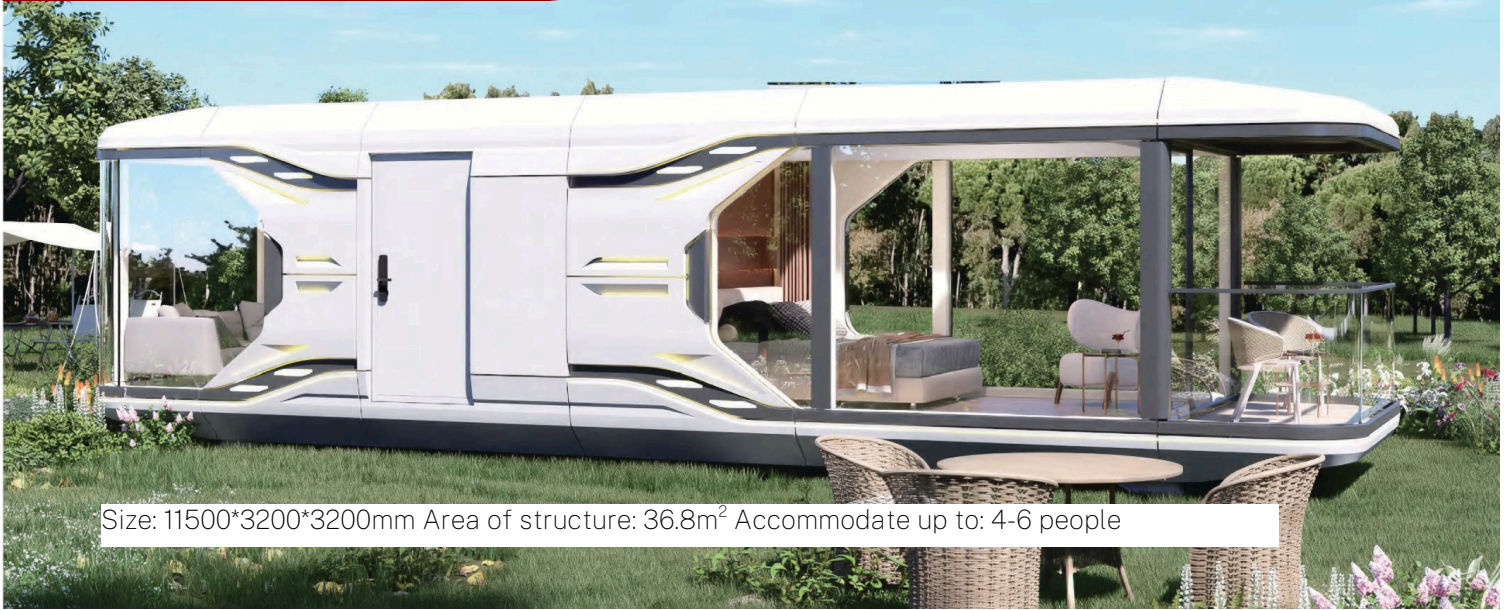

Size: 11500\*3200\*3200mm Area of structure: 36.8m<sup>2</sup> Accommodate up to: 4-6 people

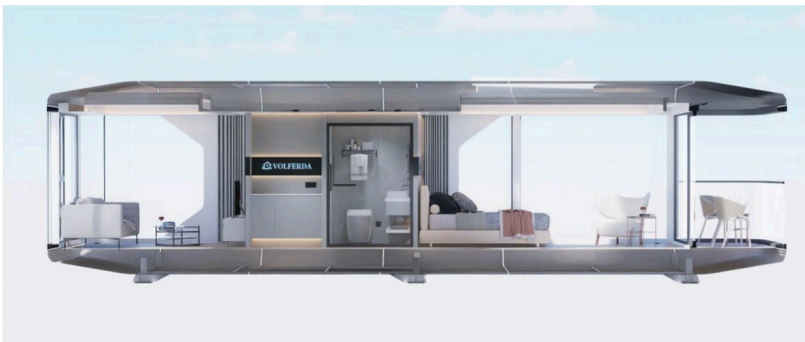

Interior layout for cold regions

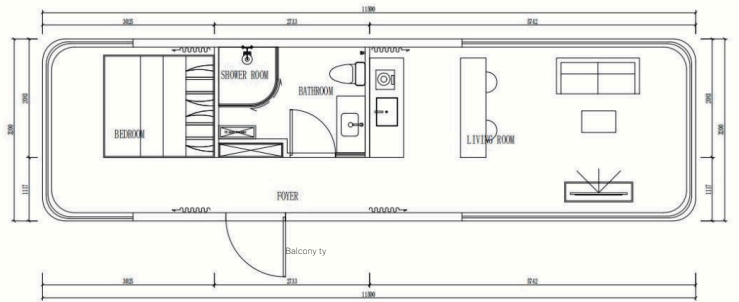

No balcony

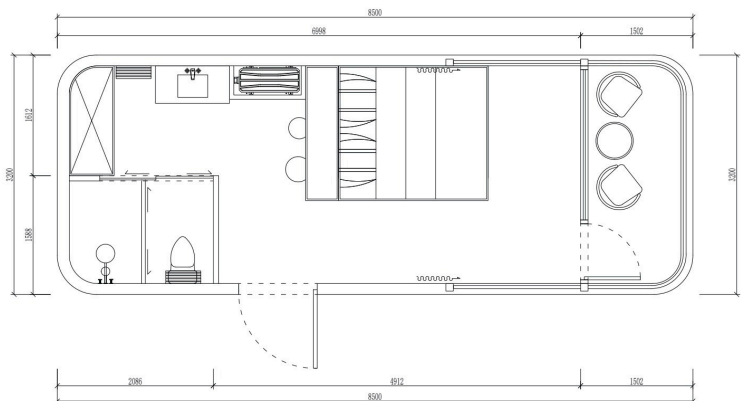

## TWO MATERIALS ARE AVAILABLE

- Carbon crystal plate
  - Aluminum plate
- And the interior layout can be changed and customized needed.

No balcony

Balcony Type

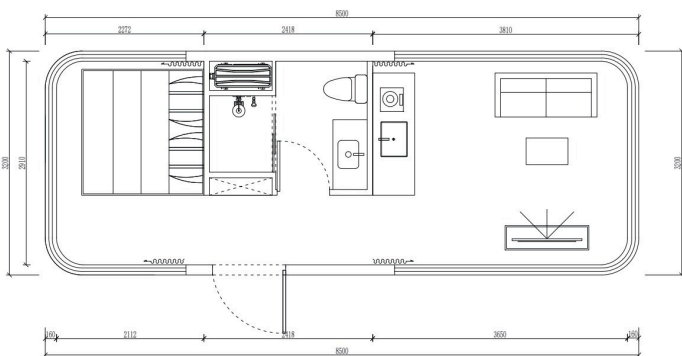

# JH-D8



Balcony Type  
Ground floor size: 12000\*3200\*3200mm  
Second floor size: 7100\*3000\*2250mm  
Area of structure: 59.7m<sup>2</sup>  
Accommodate up to: 8-12people

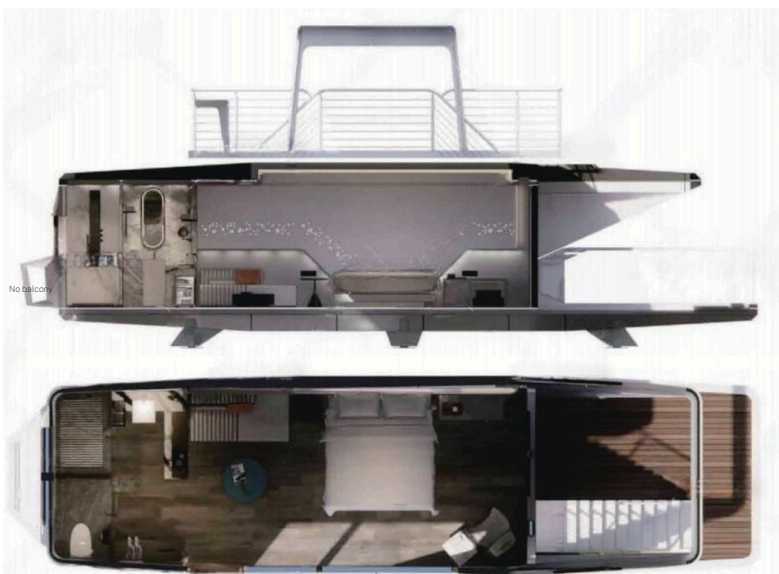

## OPTIONAL SIZE

Balcony Type  
Ground floor size: 9000\*3200\*3200mm  
Second floor size: 6000\*3000\*2250mm  
Area of structure: 46.8m<sup>2</sup> Accommodate  
up to: 8-10 people

# JH-D6



Size: 11500\*2250\*2450mm Area of structure: 25.8m<sup>2</sup> Accommodate up to : 4-6 people

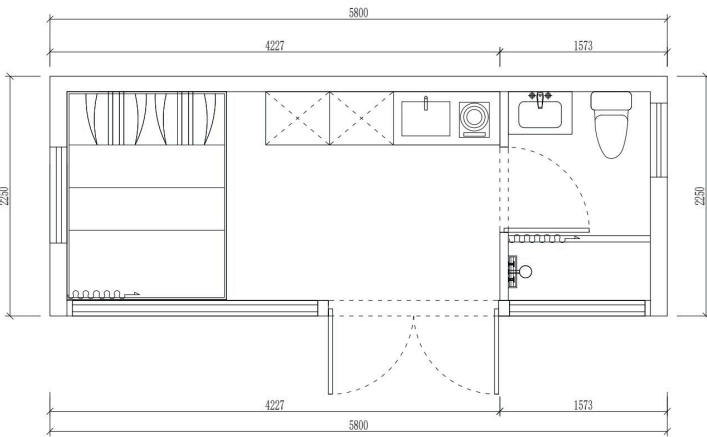
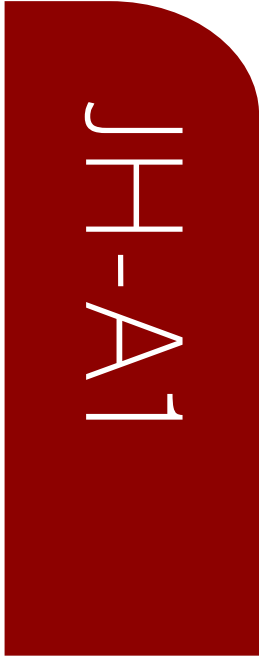

Size: 5800\*2250\*2450mm Area of structure: 13m<sup>2</sup> Accommodate up to : 1-2 people



Size: 8500\*2250\*2450mm Area of structure: 19.1m<sup>2</sup> Accommodate up to : 1-4 people

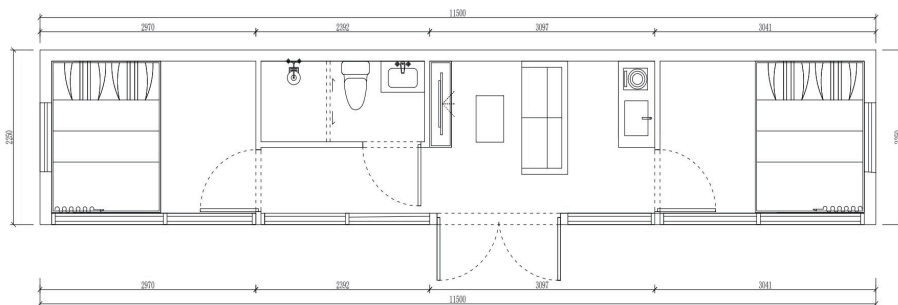
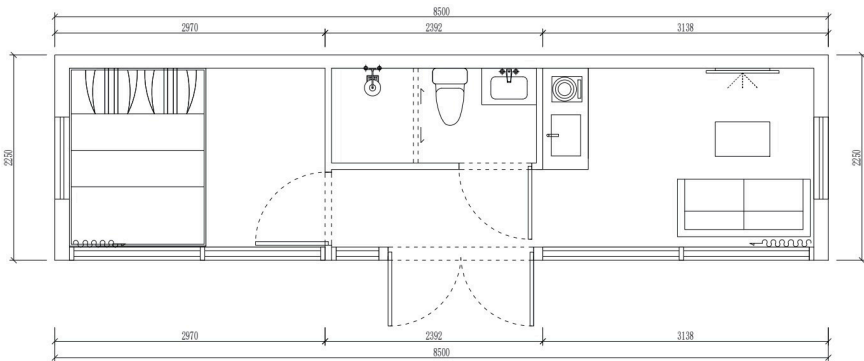

Size: 11500\*2250\*2450mm Area of structure: 25.8m<sup>2</sup> Accommodate up to : 4-6 people





JH-A2  
Glass steel apple cabin

Size: 5800\*3000\*3200mm Area of structure: 17.4m<sup>2</sup>  
Accommodate up to: 1-2 people

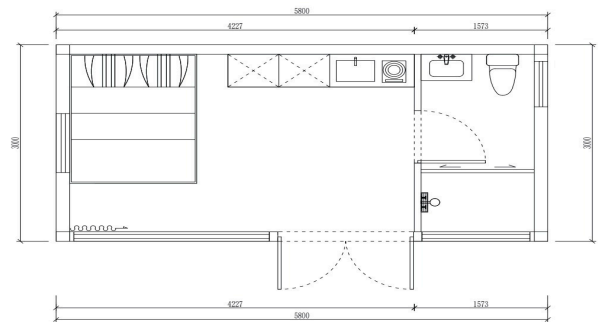

Size: 5800\*3000\*3200mm Area of structure: 17.4m<sup>2</sup>  
Accommodate up to: 1-2 people

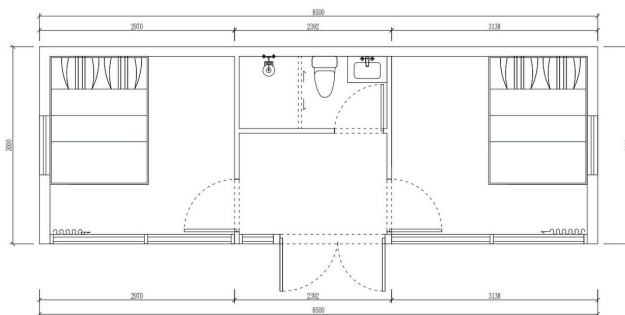

Size: 8500\*3000\*3200mm  
Area of structure: 25.5m<sup>2</sup>  
Accommodate up to: 2-6 people

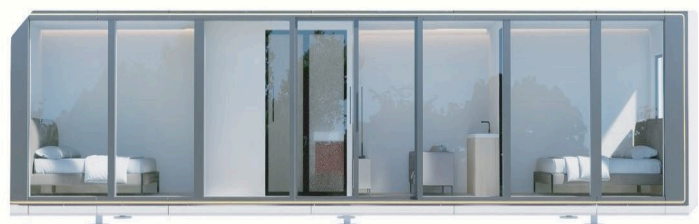
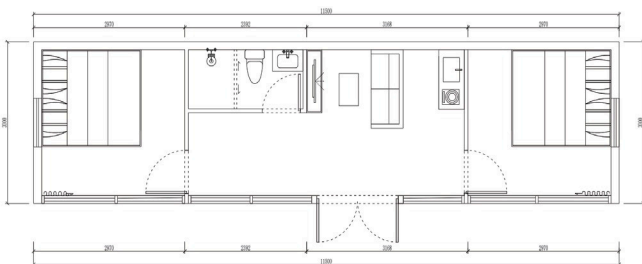

Size: 11500\*3000\*3200mm Area of structure: 34.5m<sup>2</sup>  
Accommodate up to: 3-8 people

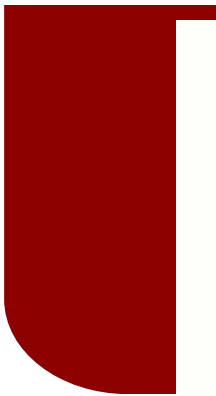

# OPTIONAL SIZE

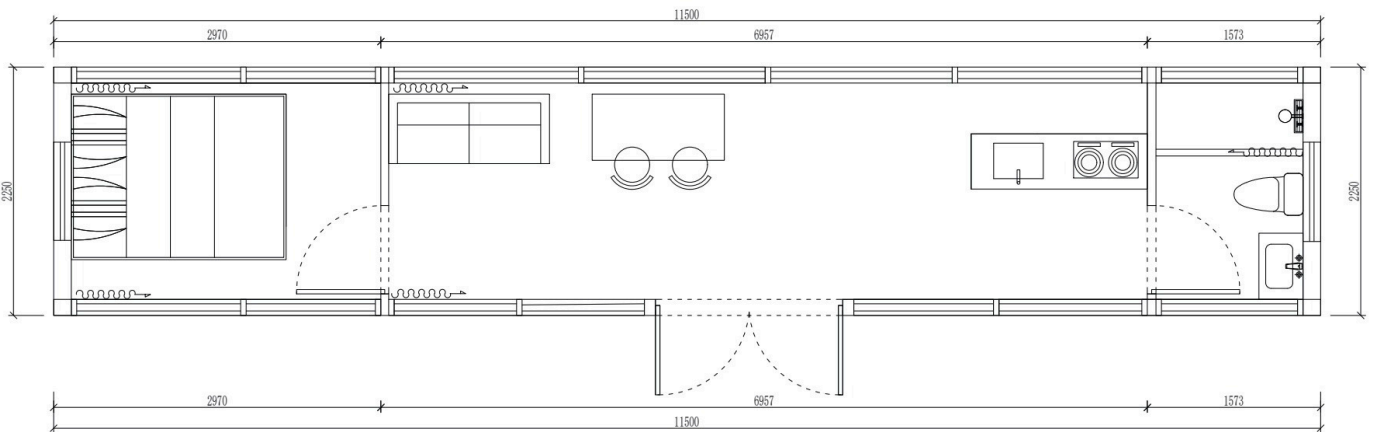

Size: 11500\*2250\*2450mm Area of structure: 25.8m<sup>2</sup>  
Accommodate up to: 2-6 people



JH-D1 Glass steel apple cabin

Size: 5800\*3000\*3200mm Area of structure: 17.4m<sup>2</sup>  
Accommodate up to: 1-2 people

**Ground floor**

Size: 11500\*4500\*2450mm  
Area of structure: 51.7m<sup>2</sup>  
Accommodate up to: 4-10 people

**Second Floor**

Size: 11500\*2250\*2450mm Pavilion  
11500\*4500\*2450mm Area of structure: 25.8m<sup>2</sup>/51.7m<sup>2</sup>  
Accommodate up to: 4-10 people

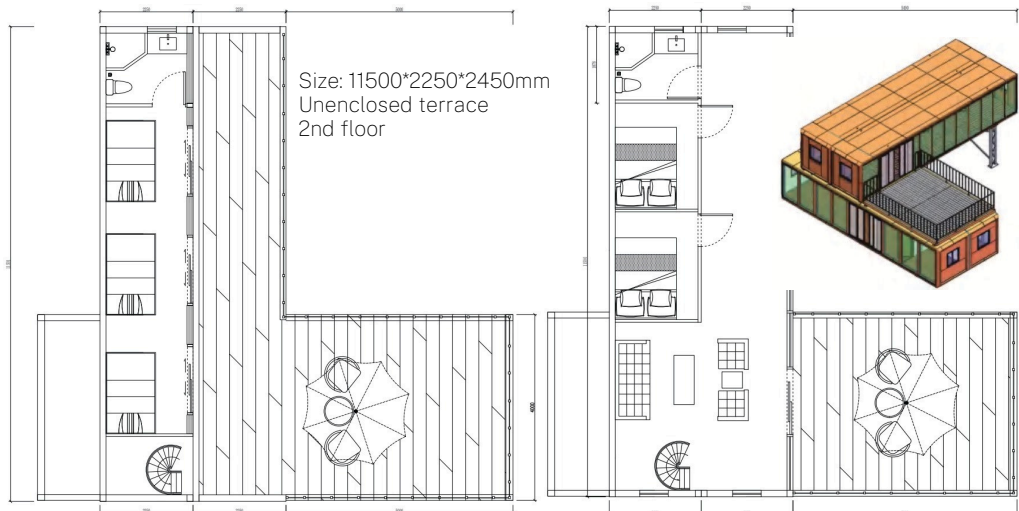
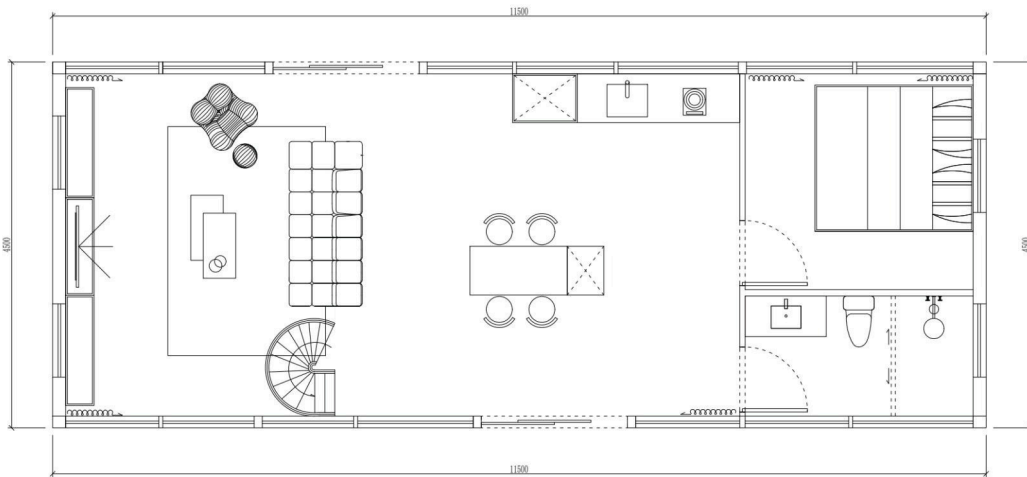

Size: 11500\*4500\*2450mm  
Enclosed cabin  
half terrace 2nd floor

# JH-D2

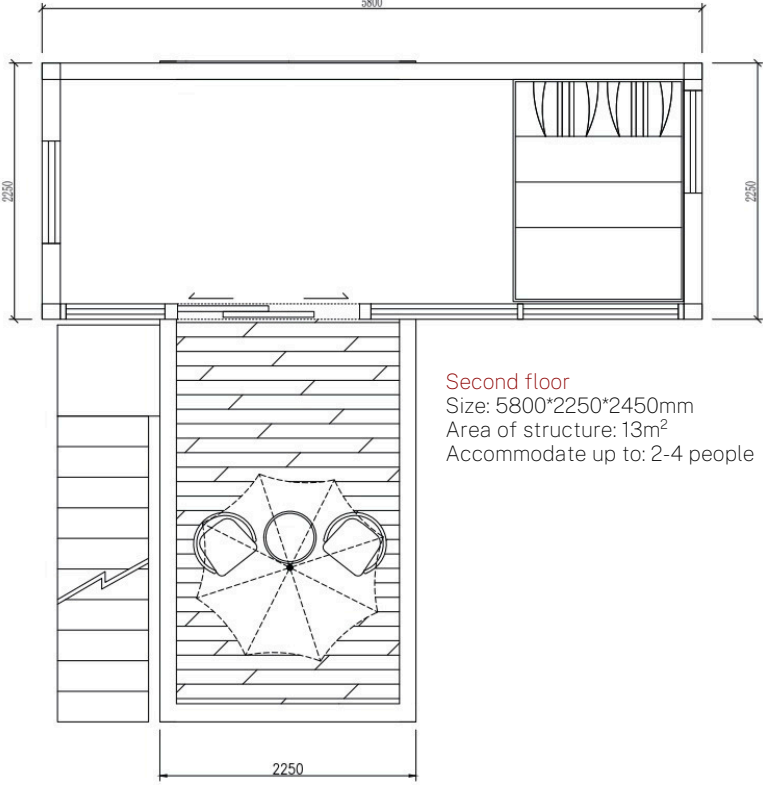
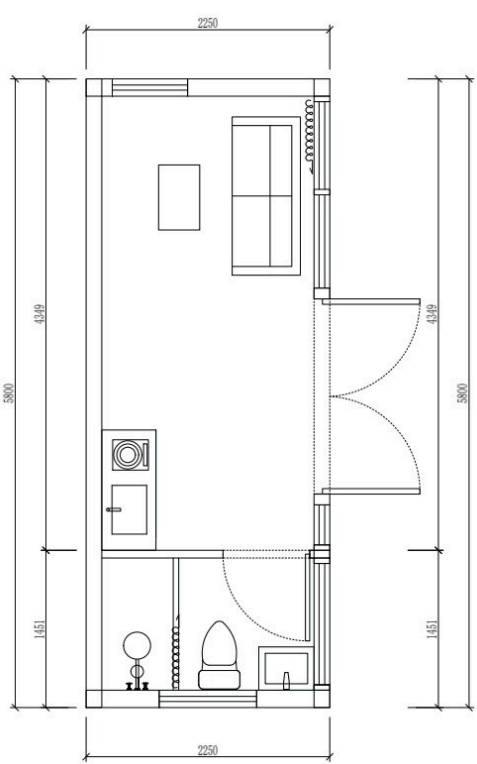

**Second floor**  
Size: 5800\*2250\*2450mm  
Area of structure: 13m<sup>2</sup>  
Accommodate up to: 2-4 people

**Ground floor**  
Size: 5800\*2250\*2450mm  
Area of structure: 13m<sup>2</sup> Accommodate up to: 2-4 people

# JH-D3



Ground floor  
Size: 11500\*2250\*2450mm  
Area of structure: 132.2m<sup>2</sup>  
Accommodate up to: 8-16people



The four hulls are spliced into two layers

OPTIONAL  
SIZE



# JH-D4



## OPTIONAL SIZE

**Second floor**  
Size: 5800\*2250\*2450mm  
Area of structure: 13m<sup>2</sup>  
Accommodate up to: 2-4 people



**Ground floor**  
Size: 5800\*2250\*2450mm  
Area of structure: 13m<sup>2</sup>  
Accommodate up to: 2-4 people



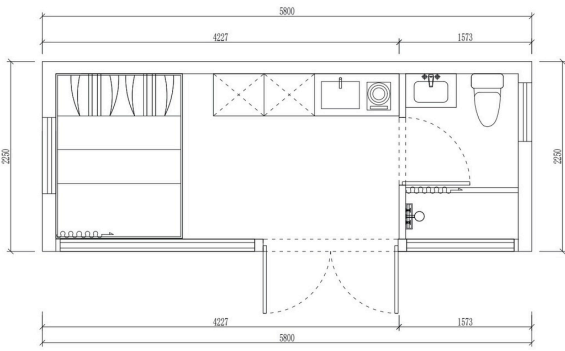

# JH-T1

Size: 8500\*2250\*2450mm Accommodate up to: 2-4 people  
Area of structure: 19.1m<sup>2</sup>

Size: 11500\*2250\*2450mm Accommodate up to: 2-6 people  
Area of structure: 25.8m<sup>2</sup>



# JH-M1

Size: 2250\*2250\*2250mm  
Area of structure: 5m<sup>2</sup>  
Accommodate up to: 1-2 people

# JH-M2

Size: 2250\*2250\*2250mm  
Area of structure: 5m<sup>2</sup>  
Accommodate up to: 1-2 people



# JH-QQ

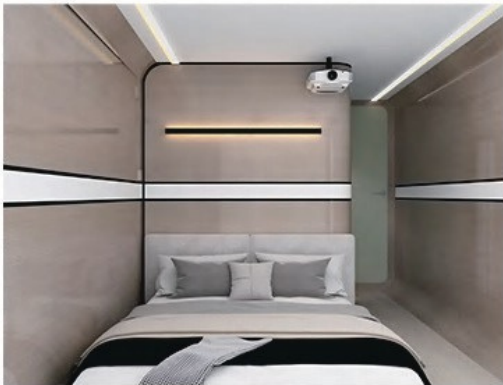

Size: 5500\*2250\*2450mm (including bathroom)  
Area of structure: 12.4m<sup>2</sup>  
Accommodate up to: 1-2 people

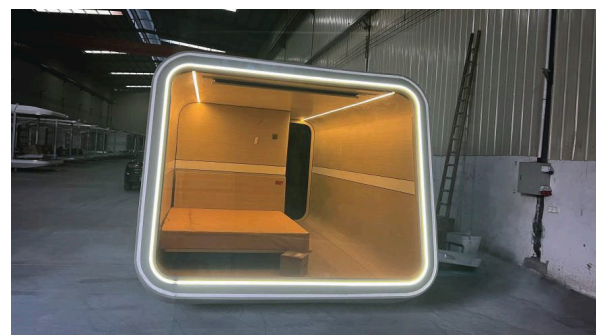

# Starry Sky Room

production factories in Qatar

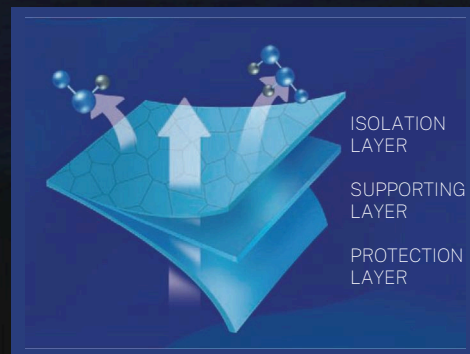

Crafted With

# Exquisite Quality

Super GB wall thickness aluminum frame  
Polymer PC endurance plate is used as the  
main material

20 years rubber strip warranty

Excellent air tightness

Mold plastic hot bending

Class B fireproof PC German Bayer board

THERMAL INSULATION

HIGH-END QUALITY

SUNSHADE

SECURITY

VENTILATION SYSTEM

LONG LIFE

PRIVACY PROTECTION



ENGINEERING CASE





# ENGINEERING CASE



H+4500

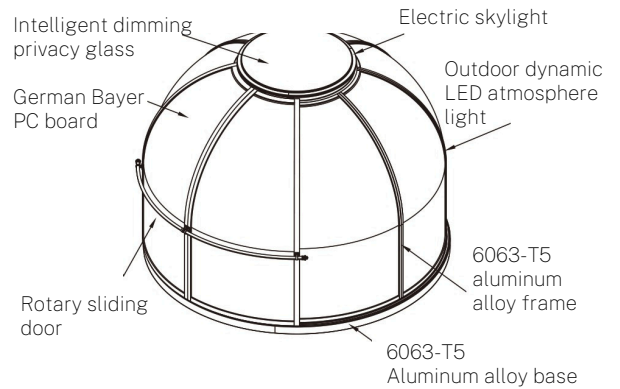
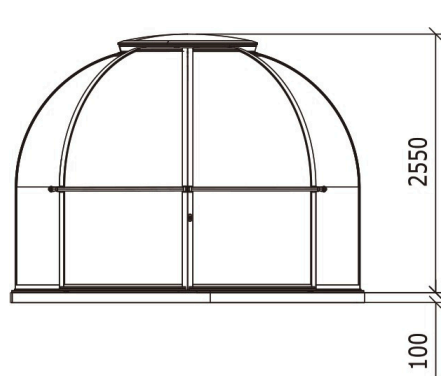
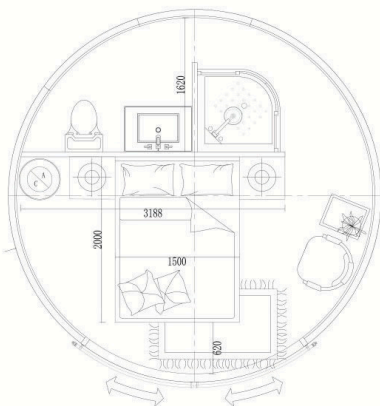

# PARAMETER DETAILS

Project	Project Technical Parameter	
Main structure system	Type	HT-TC- ø4.5(Starry Castle)
	Length of side	4.5m
	Hem width	4.5m
	Top height	2.75m
	Interior area	15.9 m <sup>2</sup>
	Circular lobe number	10 pieces
	Frame material	6063-T5 Aluminum profile (three colors optional)
	Material of wall	PC board 3.0mm thickness
	Gate system	Rotary sliding door
	Wind load	100 km /h(0.5KN/ m <sup>2</sup> )
Interior Floor (Optional)	Height	100mm
	Materials	Aluminum circle beam, aluminum keel, 18mm solid wood Laminated, PVC surface locking floor
Intelligent lighting system in space	Roof	LED main light source (remote control adjustable) standard
	Bottom	LED auxiliary light source (remote control adjustable) standard
Package Weight	Package size (mm)	Wooden box size (mm)-3250×1830×1390
	Volume	8.3m <sup>3</sup>
	Theoretical weight	600kg / suit (excluding floor base)
Optional accessories	<ul style="list-style-type: none"> <li>• Indoor floor • Curtain • Dimmer skylight • Electric lifting skylight • Fresh air ventilator • Outdoor LED ambient light</li> <li>• Air to air conditioning • Electric intelligent moving door</li> <li>• Waterproof outdoor smart lock • Aluminum base</li> </ul>	
Usage Scenarios	Various campsites in scenic spots ,Garden View, Spa Resort, Water Park Lounge, Rest Leisure Travel Holiday, Internet celebrity Home stay, Specialty Restaurant, Villa Sun Room, Gym, Chess tea room, etc	

## Comment

Product color: Tiffany Blue, metal sand gray, Hermes Orange.

• Is ofr optional configuration The company reserves the right to modify the parameters, configuration, color, material and other information of the product and the right to final interpretation. If the materials provided are changed, the latest release shall prevail.

H+4560

360°

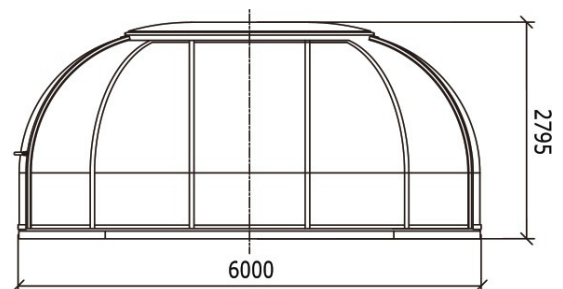
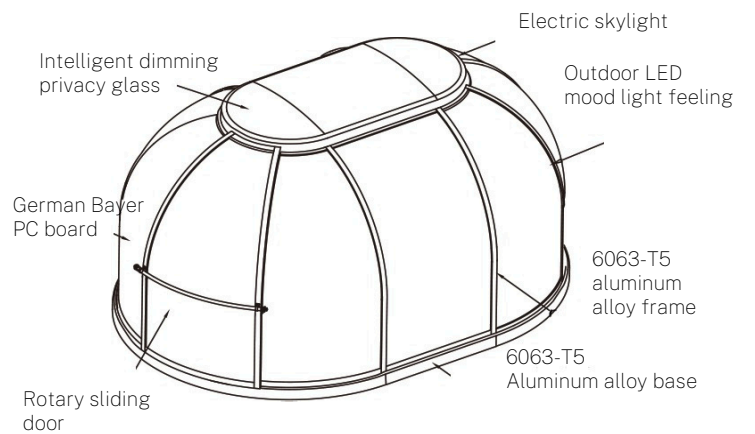
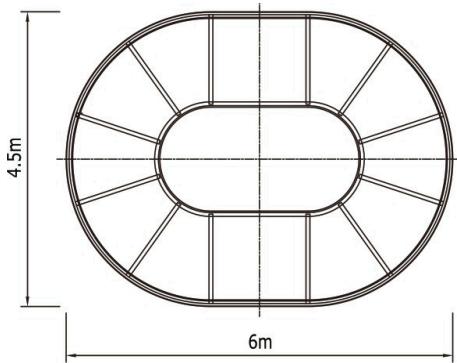

# PARAMETER DETAILS

Project	Project Technical Parameter	
Main structure system	Type	HT-TC-4.5×6.0
	Length of side	6m
	Hem width	4.5m
	Top height	2.75m(Excluding skylight lifting height)
	Interior area	22.65 m <sup>2</sup>
	Circular lobe number	12 pieces
	Frame material	6063-T5 Aluminum profile (three colors optional)
	Material of wall	PC board 3.0mm thickness
	Gate system	Flat door (open outside)
	Wind load	100 km /h(0.5KN/ m <sup>2</sup> )
Interior Floor (Optional)	Height	100mm
	Materials	Aluminum circle beam, aluminum keel, 18mm solid wood Laminated, PVC surface locking floor
Intelligent lighting system in space	Roof	LED main light source (remote control adjustable) standard
	Bottom	LED auxiliary light source (remote control adjustable) standard
Package Weight	Package size (mm)	Wooden box size (mm)-3300×1850×1920
	Volume	11.72m <sup>3</sup>
	Theoretical weight	680kg / suit (excluding floor base)
Optional accessories	<ul style="list-style-type: none"> <li>• Indoor floor • Curtain • Dimmer skylight • Electric lifting skylight • Fresh air ventilator • Outdoor LED ambient light</li> <li>• Air to air conditioning • Electric intelligent moving door</li> <li>• Waterproof outdoor smart lock • Aluminum base</li> </ul>	
Usage Scenarios	Various campsites in scenic spots ,Garden View, Spa Resort, Water Park Lounge, Rest Leisure Travel Holiday, Internet celebrity Home stay, Specialty Restaurant, Villa Sun Room, Gym, Chess tea room, etc	

## Comment

Product color: Tiffany Blue, metal sand gray, Hermes Orange.

• Is ofr optional configuration The company reserves the right to modify the parameters, configuration, color, material and other information of the product and the right to final interpretation. If the materials provided are changed, the latest release shall prevail.

# Dome Starry Sky Room Series



**Starry Sky Room - ø3.0**  
 • ø: 3000 H:2450 Area: 7.06m<sup>2</sup>  
 • 1-2 People  
 • Applicable Scenarios  
 Café Western Restaurant



**Starry Sky Room - ø3.5**  
 • ø: 3500 H:2600 Area: 9.62m<sup>2</sup>  
 • 1-2 People  
 • Applicable Scenarios Café  
 Western Restaurant



**Starry Sky Room - ø4.0**  
 • ø: 4000 H:2750 Area:12.56m<sup>2</sup>  
 • Bed & Breakfast for 1-2 People  
 Restaurant for 8-10 People  
 Lounge, Tea Room  
 Multipurpose Room



**Starry Sky Room - ø4.5**  
 • ø: 4500 H:2750 Area: 15.9m<sup>2</sup>  
 • Bed & Breakfast for 1-2 People  
 Restaurant for 6-10 People  
 Lounge, Tea Room  
 Multipurpose Room



**Starry Sky Room - ø5.0**  
 • ø: 5000 H:2750 Area: 19.62m<sup>2</sup>  
 • Bed & Breakfast for 1-2 People  
 Restaurant for 8-16 People  
 Lounge, Tea Room,  
 Multipurpose Room



**Starry Sky Room - ø5.5**  
 • ø: 5500 H:3000 Area: 23.72m<sup>2</sup>  
 • Bed & Breakfast for 2-4 People  
 Restaurant for 10-20 People  
 Lounge, Tea Room, Multipurpose  
 Room



**Starry Sky Room - ø6.0**  
 • ø: 6000 H:3300 Area: 28.2m<sup>2</sup>  
 • Bed & Breakfast for 1-2 People  
 Restaurant for 16-26 People  
 Lounge, Tea Room  
 Multipurpose Room



**Starry Sky Room - ø6.5**  
 • ø: 6500 H:3300  
 Area: 33.1m<sup>2</sup>  
 • Bed & Breakfast for 2-4 People  
 Restaurant for 16-30 People  
 Lounge, Tea Room  
 Multipurpose Room

# Oval Luxury Starry Sky Room Series

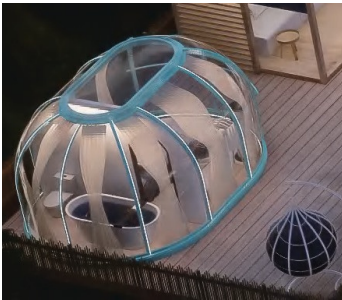

Starry Sky Room - ø3.0-4.5

- ø: 3000 L:4500 H:3000
- Area: 12
- Bed & Breakfast for 1-2 People
- Restaurant for 3-5 People
- Lounge, Tea Room, Multipurpose Room



Starry Sky Room - ø3.5-5.5

- ø: 500 L:5500 H:2650
- Area: 14.87
- Bed & Breakfast for 1-2 People
- Restaurant for 6-10 People
- Lounge, Tea Room, Multipurpose Room



Starry Sky Room - ø4.0-5.5

- ø: 4000 L:5500 H:2750
- Area: 18.5m<sup>2</sup>
- Bed & Breakfast for 1-2 People
- Restaurant for 8-10 People
- Lounge, Tea Room
- Multipurpose Room



Starry Sky Room - ø4.5-6.0

- ø: 4500 L:6000 H:2750
- Area: 22.65m<sup>2</sup>
- Bed & Breakfast for 2-4 People
- Restaurant for 8-12 People
- Lounge, Tea Room
- Multipurpose Room



Starry Sky Room - ø5.0

- ø: 5000 H:6500
- Area: 23m<sup>2</sup>
- Bed & Breakfast for 2-4 People
- Restaurant for 6-10 People
- Lounge, Tea Room,
- Multipurpose Room



Starry Sky Room - ø5.5-7.0

- ø: 5500 L:7000 H:2750
- Area: 27.12m<sup>2</sup>
- Bed & Breakfast for 2-4 People
- Restaurant for 8-18 People
- Lounge, Tea Room, Multipurpose Room



Starry Sky Room - ø6.0-7.5

- ø: 6000 H:3300
- Area: 37.26m<sup>2</sup>
- Bed & Breakfast for 2-4 People
- Restaurant for 16-26 People
- Lounge, Tea Room
- Multipurpose Room



Starry Sky Room - ø6.5-8.0

- ø: 6500 L:8000 H:3300
- Area: 42.9m<sup>2</sup>
- Bed & Breakfast for 2-4 People
- Restaurant for 16-30 People
- Lounge, Tea Room
- Multipurpose Room

# MODE OF TRANSPORT

## Foreign mode of transport

After the external packaging of the product is finished, it is transported in the container. Products from the factory to the site of the camp during the journey, will adopt strict safety protection measures to ensure safety and stability in transportation.



# PRODUCT APPLICATION SCENARIOS



Wild luxury accommodation  
Outdoor equipment exhibition

Theme concert  
Design experience week



The newly opened establishment comprises a fine dining restaurant, a cozy café, and an exquisite B&B with stunning views of the stars.



Mobile Shop  
Mobile House  
Mobile/sharing/ecology



Travel to study  
Education and medical care  
Health care and old-age care  
League building and expansion





JOHA Production Base



The total area of JOHA factory is about 40,000 square meters, more than 200 production personnel, monthly capacity reach 500 units. The core production team are all founders. Adhering to the production and management philosophy of providing customers with the best, highest quality, most ideal and most up-to-date products, each production and delivery process of products is strictly controlled, in order to achieve the best product quality and smart appearance

## HONORS AND CERTIFICATES





# HOW TO FIND US

## WEB

[www.Johasmarthouses.com](http://www.Johasmarthouses.com)

## ADDRESS

153 Hoi Bun Road, Fan Kwai Tong, Hong Kong

 **+852 9018 7164**

Joha Industry. Ltd  
(Joha Smart Home)